



Lighting

Lamps and fittings



Victory lighting manufactures a wide range of lighting, heating and UV products for many different sectors of industrial and domestic markets, literally covering the whole spectrum.

The company's roots lie in the lighting sector. Victory arose as a spinoff from Osram's UK manufacturing facility, making a variety of incandescent lamps for special contracts. Since then the company has embraced new technology to move on and develop today's high-tech product range.

Old shapes, new technology

The significant energy saving of LEDs means that naturally many of our lighting products use this technology, but to make sure that they fit existing fittings, they are shaped to conform to conventional shapes. This includes LED tubes that can be used in fluorescent fittings.



LED

The LED range comprises of retrofit lamps and T8 tubes. Spectacular savings in energy cost in commercial applications can be achieved.

LED striplights

Highly adaptable lengths of white and coloured LEDs for creative lighting.

High bay

Energy-efficient LED lighting for large areas.

Decorative

These popular lamp shapes are available with incandescent filaments or filament-shaped LEDs.

Drivers

Where products require drivers, such as striplights, Victory can supply these too.



Research and development

Victory's R&D team is constantly developing new products and finding new applications for them. Products are extensively tested for performance and compliance at our R&D centre in the UK.

Victory Lighting is ISO 9001 accredited for its facilities both in the UK and in China. The company additionally operates under its own quality policy.



Decorative

Victory's decorative lightbulbs are based on antique bulb shapes to create a retro lighting effect. They emit a warm, feel-good, glow that works equally as well at home as in commercial situations such as restaurants and bars. They are available with conventional filaments, or energy-saving LEDs configured in filament shapes. For an extra warm look, some LED versions are available with a gold finish on the glass.



G125



ST64 - Pear



A60 - Classic



T45 - Tube



G95 - Globe

Decorative range

| Code | Type | Finish | Watts | Cap | Dimensions (mm) | |
|------------|------|--------|-------|---------|-----------------|-----|
| | | | | | D | L |
| LED | | | | | | |
| 45240420 | G95 | Clear | 4 | E27/ES | 95 | 140 |
| 45240430 | G95 | Clear | 4 | B22/BC | 95 | 140 |
| 45240421 | G95 | Gold | 4 | E27/ES | 95 | 140 |
| 45240431 | G95 | Gold | 4 | B22/BC | 95 | 140 |
| 45240422 | G125 | Clear | 4 | E27/ES | 125 | 170 |
| 45240432 | G125 | Clear | 4 | B22/BC | 125 | 170 |
| 45240423 | G125 | Gold | 4 | E27/ES | 125 | 170 |
| 45240433 | G125 | Gold | 4 | B22/BC | 125 | 170 |
| 46240420 | ST64 | Clear | 4 | E27/ES | 64 | 140 |
| 46240430 | ST64 | Clear | 4 | B22/BC | 64 | 140 |
| 46240421 | ST64 | Gold | 4 | E27/ES | 64 | 140 |
| 46240431 | ST64 | Gold | 4 | B22/BC | 64 | 140 |
| 44240420 | A60 | Gold | 4 | E27/ES | 60 | 100 |
| 44240430 | A60 | Gold | 4 | B22/BC | 60 | 100 |
| 43240340 | C35 | Clear | 3 | E14/SES | 35 | 102 |
| 42240221 | T45 | Clear | 2 | E27/ES | 45 | 111 |
| 42240231 | T45 | Clear | 2 | B22/BC | 45 | 111 |

| Code | Type | Finish | Watts | Cap | Dimensions (mm) | |
|-----------------|------|--------|-------|--------|-----------------|-----|
| | | | | | D | L |
| Filament | | | | | | |
| 90246016 | ST64 | Clear | 60 | E27/ES | 64 | 140 |
| 90246017 | ST64 | Clear | 60 | B22/BC | 64 | 140 |
| 90244014 | ST64 | Clear | 40 | E27/ES | 64 | 140 |
| 90244015 | ST64 | Clear | 40 | B22/BC | 64 | 140 |
| 90244073 | ST64 | Gold | 40 | E27/ES | 64 | 140 |
| 90244074 | ST64 | Gold | 40 | B22/BC | 64 | 140 |
| 90244018 | G125 | Clear | 40 | E27/ES | 125 | 170 |
| 90244019 | G125 | Clear | 40 | B22/BC | 125 | 170 |
| 90244020 | G95 | Clear | 40 | E27/ES | 95 | 140 |
| 90244021 | G95 | Clear | 40 | B22/BC | 95 | 140 |
| 90244013 | R80 | Clear | 40 | E27/ES | 80 | 130 |
| 90244022 | R80 | Clear | 40 | B22/BC | 80 | 130 |

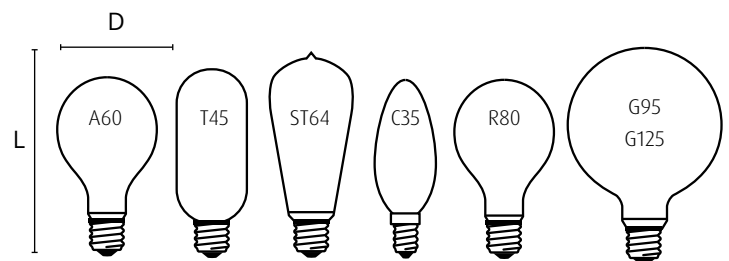

Voltage: 240V
 Colour temp.: 2700-3000K

Dimmable: LED: No / Filament: Yes
 Life: LED: 20,000 hours / Filament: 1,000 hours



LED retrofit lamps and T8 tubes

LED retrofit lamps can be used as a direct replacement for existing 12V or 240V halogen lamps. With energy use reduced by as much as 80%, they offer excellent Return On Investment. Victory GU10 and MR16 LEDs can be used as direct replacement for halogen lamps.

T8 LED tubes can be used as a direct replacement for fluorescent tubes in fittings with magnetic ballasts. A replacement starter is needed and one of these is supplied with each tube. Fittings with electronic ballasts need a simple wiring adjustment to bypass the ballast.



GU10

MR16 / GU5.3

LED range

| Code | Watts | Colour temp. (K) | Colour | Cap | Beam | Lumens | Dimensions (mm) | | | |
|------------------|-------|------------------|------------|-------|------|--------|-----------------|----|------|------|
| | | | | | | | A | B | C | D |
| Reflector | | | | | | | A | B | C | D |
| 41120711 | 7 | 3000 | Warm White | GU5.3 | 30° | 449 | - | 50 | - | 55 |
| 41240701 | 7 | 3000 | Warm White | GU10 | 30° | 475 | - | 50 | - | 58 |
| T8 tube | | | | | | | | | | |
| 42241650 | 16 | 4000 | White | G13 | 180° | 1600 | 26 | 29 | 1200 | 1212 |
| 42241651 | 16 | 3000 | Warm White | G13 | 180° | 1600 | 26 | 29 | 1200 | 1212 |
| 42242250 | 22 | 4000 | White | G13 | 180° | 2200 | 26 | 29 | 1500 | 1512 |
| 42242251 | 22 | 3000 | Warm White | G13 | 180° | 2200 | 26 | 29 | 1500 | 1512 |
| 42243550 | 35 | 4000 | White | G13 | 180° | ?? | 26 | 29 | 2374 | 2388 |
| 42243551 | 35 | 3000 | Warm White | G13 | 180° | ?? | 29 | 29 | 2374 | 2388 |

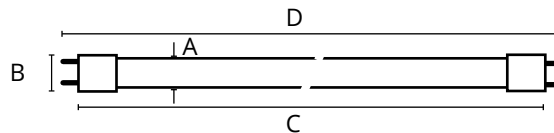
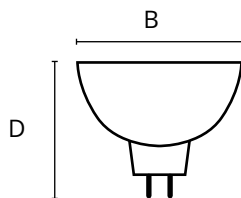

- High colour rendering index 80 Ra
- Long life - 30000 hours average rated life
- Energy efficient
- MR16 versions compatible for use with 12V AC transformers and DC drivers
- Full instant light
- Non-dimmable
- Tubes supplied with replacement starters

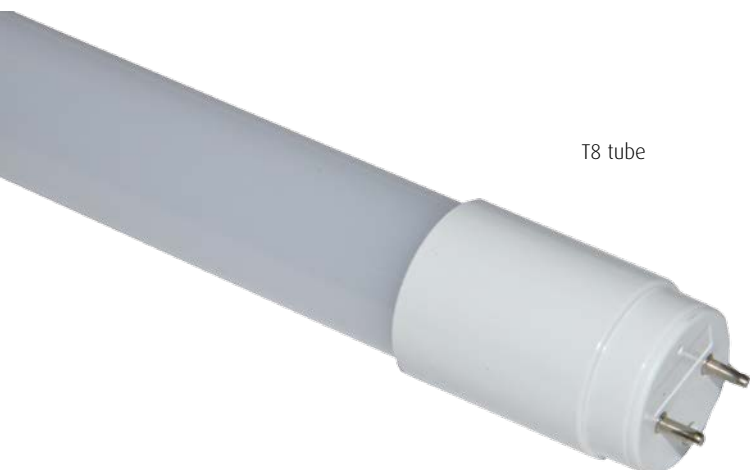

T8 tube



LED striplights

Victory LED striplights are supplied in 5m long rolls which can be cut to length at 25mm cut points. Victory can supply custom lengths with sealed ends and input supply cables fitted.

They require a driver of appropriate power. In addition, Victory's remote control unit enables colour to be changed on the RGB range.

- IP68 - can be used outdoors
- Average life of 50,000 hours
- 3M self adhesive backing tape for easy installation
- Low heat generation, safe to touch
- CE, LVD, EMC & RoHS approved



LED striplight range

| Code | Colour temp. (° K) | Colour description | Input voltage (VDC) | Power consumption (W/m) | IP rating | Working temp (°C) | Beam angle (°) | Max distance per run (m) | LED/m (no.) |
|-----------|--------------------|--------------------|---------------------|-------------------------|-----------|-------------------|----------------|--------------------------|-------------|
| VLL102WW | 2700-3500 | Warm White | 12 | 9.6 | 68 | -40 - +75 | 120 | 6 | 120 |
| VLL102CW | 6500-7200 | Cool White | 12 | 9.6 | 68 | -40 - +75 | 120 | 6 | 120 |
| VLL102RGB | RGB | Changeable | 12 | 14.4 | 68 | -40 - +75 | 120 | 6 | 60 |

Dimensions

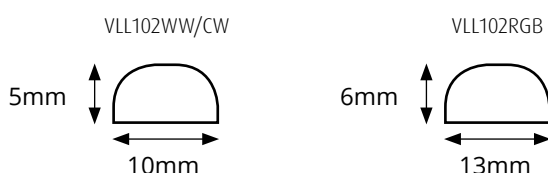

LED drivers

For striplights and other LED products that require drivers, Victory has a range of high quality products.

- IP67 - suitable for outdoor use.
- CE, LVD, EMC, &RoHS approved
- Low operating temperature
- Aluminium casing

Driver range

| Code | Output watts | Output volts (VDC) | IP rating | Working temp (°C) | Dimensions (mm) |
|----------|--------------|--------------------|-----------|-------------------|-----------------|
| VLL12020 | 20 | 12 | 67 | -30 - +60 | 160x30x20 |
| VLL12060 | 60 | 12 | 67 | -30 - +60 | 150x50x30 |
| VLL12150 | 150 | 12 | 67 | -30 - +60 | 210x70x40 |
| VLLCHR* | 144 | 12-24 | 67 | -30 - +60 | 130x64x24 |

* The VLLCHR remote RF controller includes the VLLHR handset. The VLLHR handset is also available separately as a spare.



VLLCHR (includes VLLHR)

Remote RF controller

- Enables colours to be changed remotely
- Range up to 80m, line of sight
- Control up to 10m of VLL102RGB LEDs

VLLHR



VLL12020



VLL12060

Albeo LED high bay luminaire

The award winning Albeo™ LED Luminaire utilises innovative heat-sinking and cutting-edge LED technology to replace 250 -1,000W HID, and four to eight lamp T5/T8 fluorescent luminaires, in high bay applications. Albeo can be matched with motion and daylight sensors for increased energy savings, lower maintenance costs and shorter paybacks.

- Precision lens system provides optimised illumination for open floor or racked aisles
- Utilises high brightness LEDs, 70 CRI

Albeo range

| Code | Watts | No. of modules | Lumens |
|-------|-------|----------------|--------|
| 32384 | 86 | 1 | 9,100 |
| 32411 | 113 | 2 | 12,100 |
| 32412 | 147 | 2 | 16,150 |
| 32418 | 225 | 3 | 24,250 |
| 32420 | 295 | 4 | 32,300 |



Colour temp: 4000K
Ra: 70
Rated life: 60,000h
Beam degrees: 120
Controller: Dimmable, DALI

Certification: CE
Volts: 220-240
Mounting: Cable/chain, rod or pendant (additional mounting kits required.)

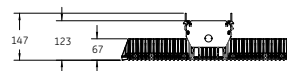
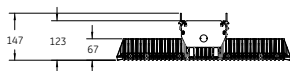
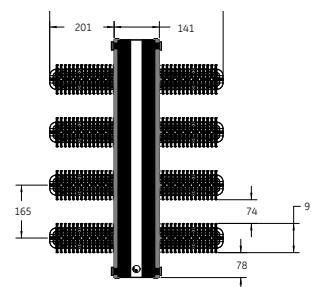
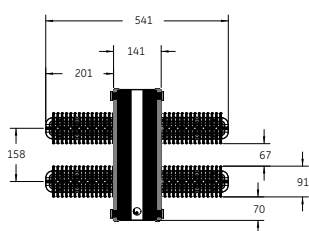
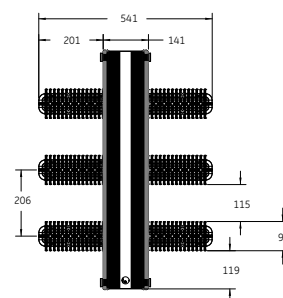
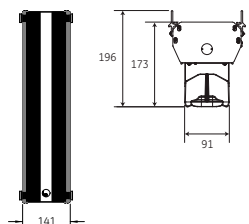

VICTORY

Victory Lighting (UK) Ltd
 Unit 3, Eastman Way, Hemel Hempstead, Hertfordshire HP2 7DU
www.victorylighting.co.uk | [e sales@victorylighting.co.uk](mailto:sales@victorylighting.co.uk) | [t +44 \(0\)1442 215200](tel:+441442215200)

© Victory Lighting (UK) Ltd 2016
 The information contained in this literature is for general information purposes only. Victory Lighting (UK) Ltd endeavours to keep the information up to date and correct, but makes no representations or warranties of any kind, express or implied, about the completeness, accuracy, reliability, suitability or availability with respect to the information, products, services, or related graphics contained in this literature.

Victory Lighting (UK) Ltd accepts no liability for any loss or damage including without limitation, indirect or consequential loss or damage, or any loss or damage whatsoever arising from loss of data or profits arising out of, or in connection with, the use of this literature.

Distributed by